

Toggle Switch, Code : C511B

The toggle switch is a type of electrical switch that is identified by the presence of handle or lever that makes it possible to control the flow of electric current/signal from a power supply to a device or within a device. C511B has fixed type and auto-return type (both single-throw and double-throw can return) movement way. The terminal block has screw terminal and solder terminal (tab terminal also can be used) and has rainproof cap. It is water-proof and oil-proof and suitable for full series products.

General Attributes

- Mounting hole : $\phi 12\text{mm}$
- Type : 15A 250VAC
- Contact : Single pole single throw ON-OFF
- Terminal : Screw terminal
- Contact resistance : $15\text{M}\Omega$ (initial)
- Insulation resistance : $100\text{M}\Omega$ (Under 500 VDC)
- Dielectric strength : 2000VAC, 50/60Hz (for 1 minute)
- Ambient temperature : $-10^{\circ}\text{C} \sim +80^{\circ}\text{C}$
- Humidity : 85% RH max.
- Life : Mechanical: 500,000 operations/min.
- Electrical : 100,000 operations/min.

Application Notes

In the role of a light indicator.
Turn a light on or off regardless of the position of the other switch on the circuit.
To control large groups of machines.
To control AC or DC power in domestic, commercial and industrial applications for operating various electrical devices and electronic equipment.
As switching circuit in Telecommunication trainer kit:
For example: for switching between Ask modulator and Bsk modulator.
In Aeroplanes and auto-mobiles for switching head lights etc.
As main switch of Air-Conditioner.

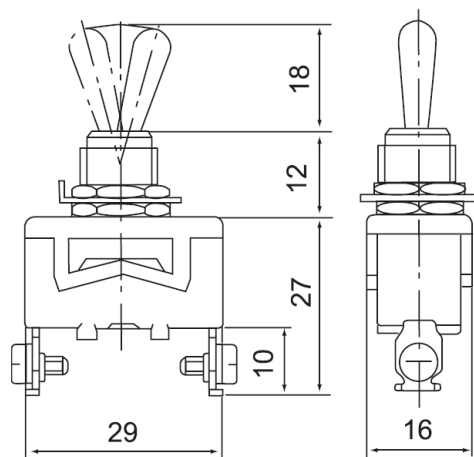

Wiring Diagram

For further information please visit : <https://goo.gl/1q8nfX>