

## Stainless Steel Code- ISO 15552 (EX ISO 6431)

Stainless steel cylinders made to ISO 15552 available in various versions and with a wide range of accessories: • with or without magnet execution • double-acting – single- or through-rod • gaskets: Polyurethane or FKM/FPM (for high temperatures) • fixing accessories, guide units and mechanical piston rod lock

### COMPONENTS

- ☐ PISTON ROD: AISI 316 steel
- ☐ HEAD: AISI 304 steel
- ☐ PISTON ROD GASKET: polyurethane or FKM/FPM
- ☐ GUIDE BUSHING: sintered bronze
- ☐ BARREL: AISI 304 steel
- ☐ ENBLOC GASKET: NBR or FKM/FPM
- ☐ MAGNET: plastroferrite
- ☐ Static O-rings: NBR or FKM/FPM
- ☐ CUSHIONING GASKET: polyurethane or FKM/FPM
- ☐ CUSHIONING NEEDLE: AISI 304 steel
- ☐ TIE ROD: AISI 316 steel
- ☐ NEEDLE-RETAINING RING: technopolymer

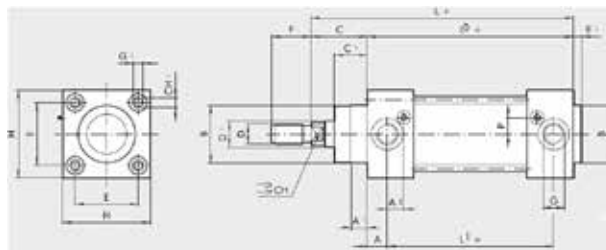

Wiring Diagram

### TECHNICAL DATA

- |   |  |
|---|--|
| <input type="checkbox"/> Max operating pressure bar | : 10   |
| <input type="checkbox"/> Temperature range °C       | : -10 to +80   |
| <input type="checkbox"/> Fluid                      | : Unlubricated air. Lubrication, if used, must be continuous   |
| <input type="checkbox"/> Bores mm                   | : 32; 40; 50; 63; 80; 100                                      |
| <input type="checkbox"/> Design                     | : Heads with tie rods  |
| <input type="checkbox"/> Standard strokes + mm      | : max 1000   |
| <input type="checkbox"/> Versions                   | : Double-acting cushioned, Double-acting through-rod cushioned |

For further information please visit : <https://goo.gl/TPYAnf>

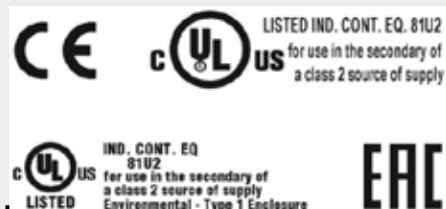

We are the authorized distributor of Metal Work in Bangladesh.