

Grippers With Three Parallel Jaws , Code- W1570160300

Double-acting grippers with three self-centring jaws, internal and external clamping. The body contains slots for mounting retracting magnetic sensors.

TECHNICAL DATA		P11-16	P11-20	P11-25	P11-60
Min./max. operating pressure	bar	2 to 7			
	MPa	0.2 to 0.7			
	psi	29 to 101			
Temperature range	°C	-10 to +80			
Fluid		20 µm filtered, lubricated or unlubricated air; lubrication if used, it must be continuous.			
Bore	mm	16	20	25	60
Single jaw stroke	mm	3	4	5	12.5
Clamping force at 6.3 bar 22 mm from the top surface, during opening and closing	N	38	62	110	900
Weight	kg	0.12	0.21	0.3	2.7
Maximum operating frequency	cycles/s	1.5	1.5	1.5	1.2

General Attributes

- Type : P11-16
- Diameter (Bore) : 16 mm
- Weight : 0.12 kg



DIMENSIONS OF GRIPPER P11-16

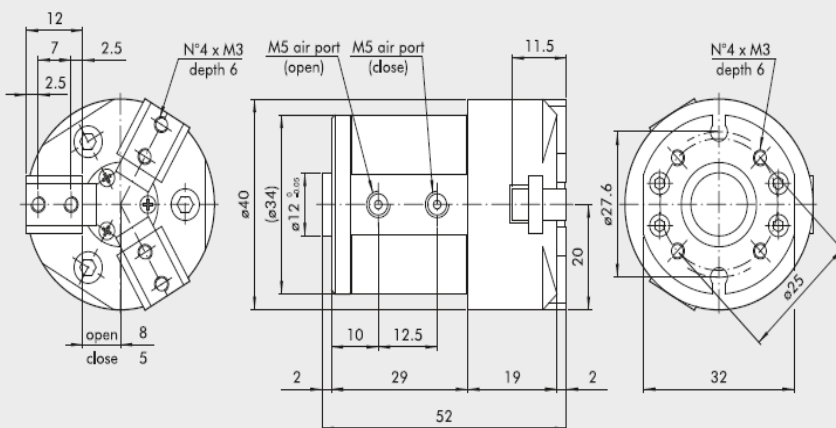

Code	Description
W1570160300	Grippers with 3 parallel jaws P11-16

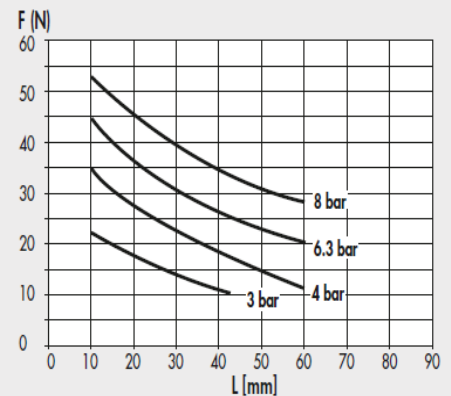

For further information please visit : <https://goo.gl/wfoWWW>

We are the authorized distributor of Metal Work in Bangladesh.