

Multiple Connection, Code- 210040008

Series PLT-10 solenoid valves can be mounted on bases complete with electrical and pneumatic connections, from 4 to 24 positions. The electric contacts of each valve are linked to a single multiple connector via a printed circuit board. The connector has 9 pins or 25 pins, pending on the model and the number of valves that can be mounted. Versions with 25-pin connectors can interface with standard field buses by means of Profibus-DP modules for Multimach (see page 2-279). The compressed-air supply is common to all the valves and can be provided on either side of the base by means of a 1/8" fitting. Connection to the utilities is via automatic integrated cartridges for Ø 4 pipe. The solenoid valve outlet is free, in a slot in the base. The bases can be secured from above using M3 screws, or on a DIN bar using a bracket (see accessories). The bases can mount various types of PLT-10 solenoid valves: 3/2 NC, 3/2 NO, with or without a manual actuator. With this modular system, you can select the desired sequence of valves (NC, NO, blind) and change it at any time.

GENERAL ATTRIBUTES

■ Description	: 8-posn. base PLT 10 9-PIN mult conn.
■ N° of PINS	: 9
■ N° of positions	: 8
■ L1	: 122.5
■ L2	: 10.6
■ L3	: 18
■ L4	: 41
■ L5	: 19.6
■ Weight [g]	: 235

COMPONENTS

Anodized aluminium base
Multi-pin electrical connector
Automatic integrated cartridges for Ø 4 pipe
Electrical connectors for PLT-10 solenoid valves mounted on printed circuit board
Securing screw
Technopolymer cover

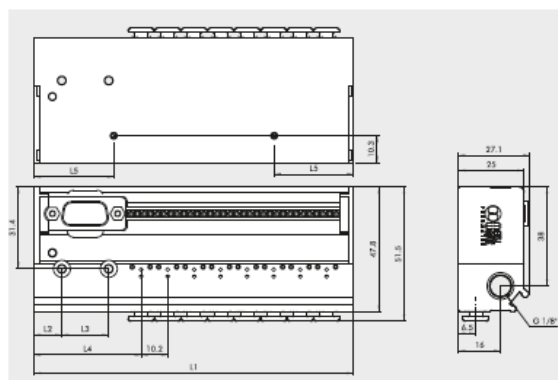

Wiring Diagram

TECHNICAL DATA

Type	: 3/2 NC ed NO
Operating temperature range (Te) °C	: 5 to 50
Fluid temperature (Tg) °C	: 5 to 50
Fluid	: Filtered, lubricated or unlubricated air
Operating life	: Over 50 million cycles
Weight g	: 12
Voltage tolerance	: ± 10 %
VMax operating frequency f	: 30 Hz
Switching factor ED	: 100 %

For further information please visit : <https://goo.gl/TPYAnf>

