

Photoelectric Sensor Tube Code : Q50RN/B0-0E

Photoelectric sensors are ideal for the detection of differences in contrast. They detect objects depending on their surface, color and material. They are inexpensive, easy to mount and align. Diffuse sensors with background suppression ensure reliable detection regardless of the surface, color and material. Their pulse width is almost constant, even with different reflectance.

General Attributes

■ Normal Sensing Range	: 0.2...6 m
■ Min Sensing Range	: 200 mm
■ emission	: red visible LED light
■ Spot Diamention	: 280 mm @ 3 m
■ operating voltage	: 10....30 Vdc
■ no-load supply current	: ≤ 40 mA
■ load current	: ≤ 200 mA
■ Outpur Voltage Drop	: ≤ 2.5 VDC @ 200 mA
■ Operating temperature range	: - 25°C...+ 60°C
■ output type	: PNP or NPN
■ protection degree	: IP67 (EN60529)
■ housing material	: body: PC/ABS; optic: PMMA

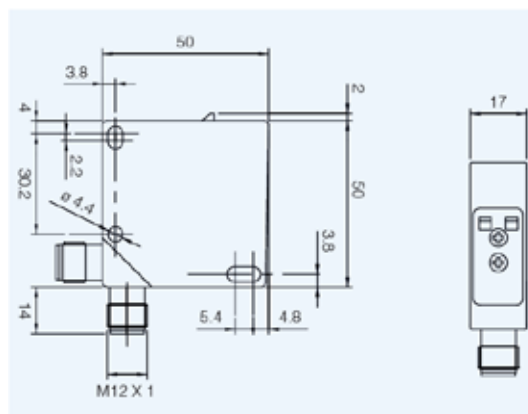

Application Notes

Counts Clear Plastic in High Speed
Detects Transparent Bottles
Warning Alarm For Bottles
Validation of cigarette Paper
Prevention of entry into restricted area

electrical diagrams

For further information please visit : <https://goo.gl/CmpksG>

We are the authorized distributor of Micro Detector in Bangladesh.