

Toggle Switch, Code : C513B

The toggle switch is a type of electrical switch that is identified by the presence of handle or lever that makes it possible to control the flow of electric current/signal from a power supply to a device or within a device. C511B has fixed type and auto-return type (both single-throw and double-throw can return) movement way. The terminal block has screw terminal and solder terminal (tab terminal also can be used) and has rainproof cap. It is water-proof and oil-proof and suitable for full series products.

General Attributes

- Mounting hole : $\phi 12\text{mm}$
- Type : 15A 250VAC
- Contact : Single pole double throw (central OFF)ON-OFF-ON
- Terminal : Screw terminal
- Contact resistance : $15\text{M}\Omega$ (initial)
- Insulation resistance : $100\text{M}\Omega$ (Under 500 VDC)
- Dielectric strength : 2000VAC, 50/60Hz (for 1 minute)
- Ambient temperature : $-10^{\circ}\text{C} \sim +80^{\circ}\text{C}$
- Humidity : 85% RH max.
- Life : Mechanical: 500,000 operations/min.
- Electrical : 100,000 operations/min.

Application Notes

- ☐ In the role of a light indicator.
- ☐ Turn a light on or off regardless of the position of the other switch on the circuit.
- ☐ To control large groups of machines.
- ☐ To control AC or DC power in domestic, commercial and industrial applications for operating various electrical devices and electronic equipment.
- ☐ As switching circuit in Telecommunication trainer kit: For example: for switching between Ask modulator and Bsk modulator.
- ☐ In Aeroplanes and auto-mobiles for switching head lights etc.
- ☐ As main switch of Air-Conditioner.

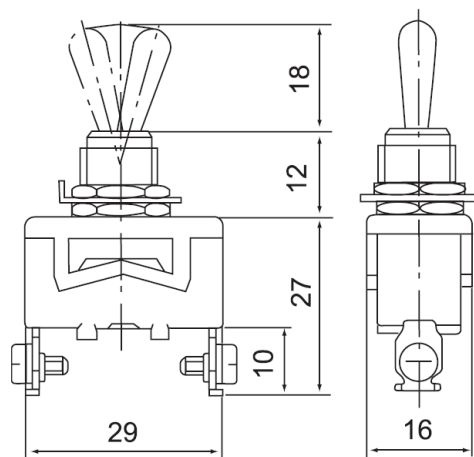

Wiring Diagram

For further information please visit : <https://goo.gl/1q8nfX>